

FITZARCHITECTS

6 PIER POINT - MARINE WALK
 SUNDERLAND - SR6 0PP
 T +44 (0)191 563 7025 F +44 (0)191 510 1746
 WWW.FITZARCHITECTS.CO.UK
 OFFICE@FITZARCHITECTS.CO.UK

CLIENT
 GLENROSE DEVELOPMENTS

PROJECT
 PROPOSED RESIDENTIAL DEVELOPMENT
 AT SHORTS OF WHITBURN

STAGE
 FEASIBILITY

DRAWING
 LEVEL 00 PLAN
 DWELLING 6

PROJECT NUMBER 1342	SCALES 1:50 @ A3
------------------------	---------------------

DRAWING NUMBER AL (00) 0300	DATE JAN 16
--------------------------------	----------------

DRAWN BY CM	CHECKED BY CRF
----------------	-------------------

REVISION	NORTH
----------	-------

REVISION	DATE AND DESCRIPTION

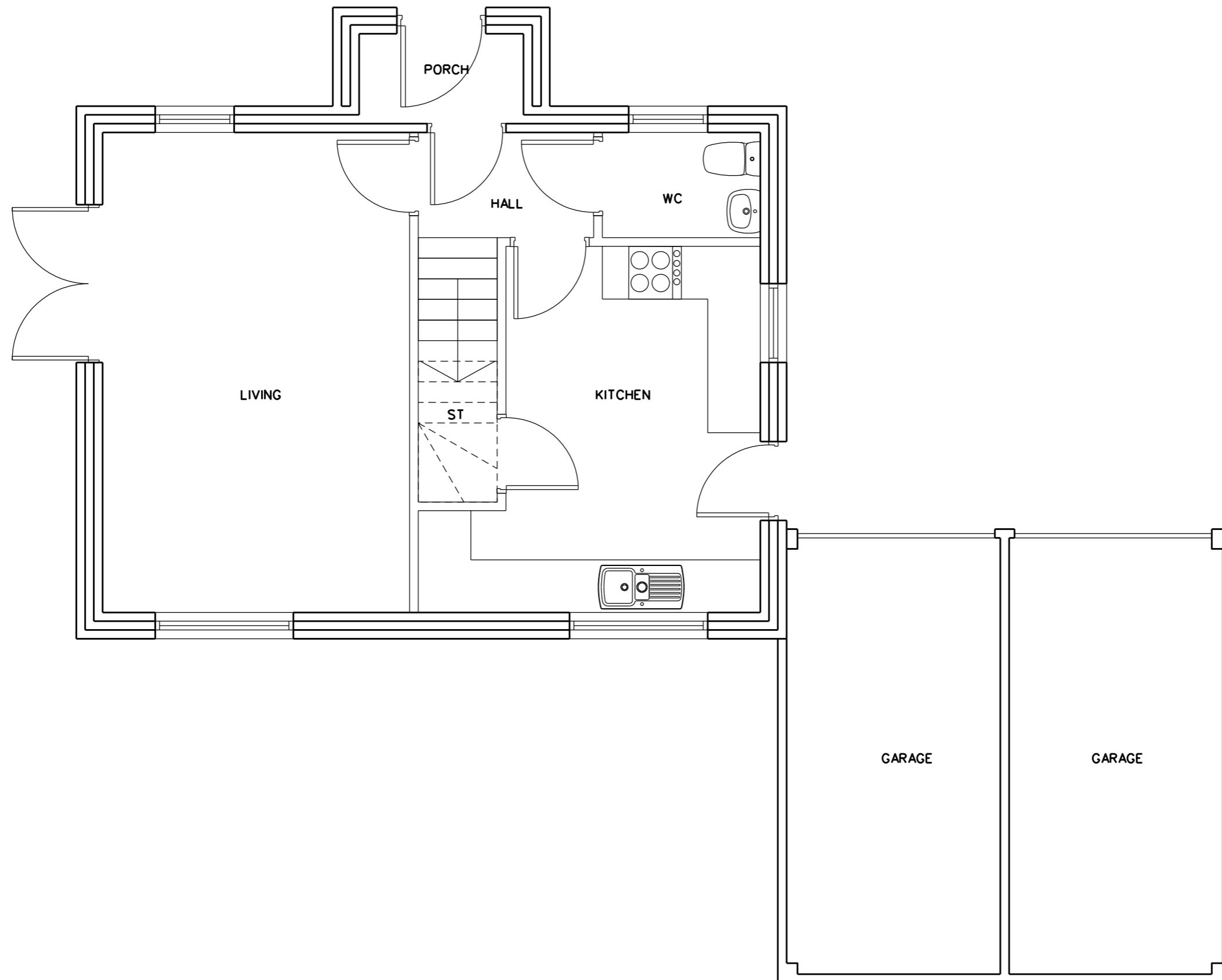

COPYRIGHT OF FITZ ARCHITECTS LIMITED
 NOT TO BE SCALED - ALL DIMENSIONS TO BE CHECKED ON SITE

← 50MM →